

# Return Duct Kit

Part No. 4035646

## Parts Included:



**Tools Required:** Torx T20 Screwdriver

**CAUTION!** Before installing duct kit, disconnect dehumidifier from electrical power and disconnect duct work if previously installed.

**Step 1:** Remove six screws (three on each side) from the dehumidifier.

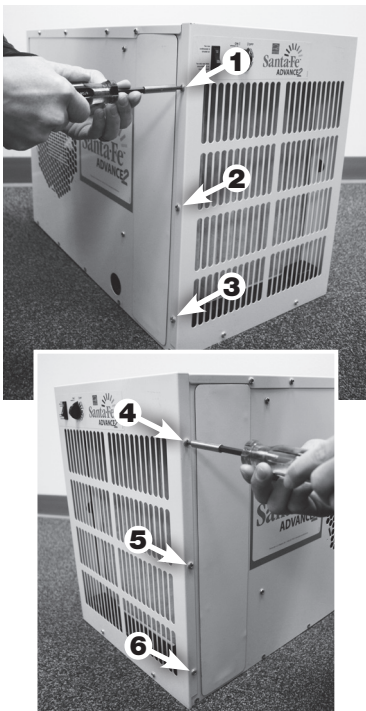

**Step 2:** Place duct kit assembly on dehumidifier and line up holes on assembly with screw holes.



**Step 3:** Using six screws previously removed, replace screws into holes to secure duct kit assembly.

