

## Start Here!

You should have received the following items:

- 1 Santa Fe Connect Monitor
- 2 Santa Fe Connect Cable (2 Ft.)
- 3 Santa Fe Connect Cable (25 Ft.)
- 4 Santa Fe Connect Water Sensor
- 5 Santa Fe Connect Water Sensor Cable (25 Ft.)
- 6 Hanging Screw



To get started connecting your new dehumidifier to the cloud, please follow these simple steps:

**Step 1:** Plug in and turn on your dehumidifier.

**Step 2:** Choose placement of the Monitor. Position the Monitor onto the back of your dehumidifier. The magnet on the back of the Monitor will hold it in place, or position the Monitor somewhere within 25 feet of the dehumidifier using the hanging screw. **DO NOT place the Monitor on the exhaust grill of the dehumidifier.**

**Step 3:** Attach the Santa Fe Connect Cable to the Monitor. Use only one of the cables provided. Choose your cable based on the length required to reach the Monitor.

**Step 4:** Attach the other end of the Santa Fe Connect Cable to your dehumidifier.

**Step 5:** This step is optional. Attach the Water Sensor to the Monitor using the Water Sensor Cable. Position the Water Sensor onto the floor.

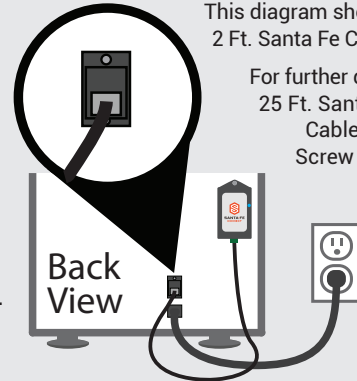

This diagram shows using the 2 Ft. Santa Fe Connect Cable.

For further distances, the 25 Ft. Santa Fe Connect Cable and Hanging Screw may be used.

TS-1068 8/18 Rev C

## Start Here!

You should have received the following items:

- 1 Santa Fe Connect Monitor
- 2 Santa Fe Connect Cable (2 Ft.)
- 3 Santa Fe Connect Cable (25 Ft.)
- 4 Santa Fe Connect Water Sensor
- 5 Santa Fe Connect Water Sensor Cable (25 Ft.)
- 6 Hanging Screw



To get started connecting your new dehumidifier to the cloud, please follow these simple steps:

**Step 1:** Plug in and turn on your dehumidifier.

**Step 2:** Choose placement of the Monitor. Position the Monitor onto the back of your dehumidifier. The magnet on the back of the Monitor will hold it in place, or position the Monitor somewhere within 25 feet of the dehumidifier using the hanging screw. **DO NOT place the Monitor on the exhaust grill of the dehumidifier.**

**Step 3:** Attach the Santa Fe Connect Cable to the Monitor. Use only one of the cables provided. Choose your cable based on the length required to reach the Monitor.

**Step 4:** Attach the other end of the Santa Fe Connect Cable to your dehumidifier.

**Step 5:** This step is optional. Attach the Water Sensor to the Monitor using the Water Sensor Cable. Position the Water Sensor onto the floor.

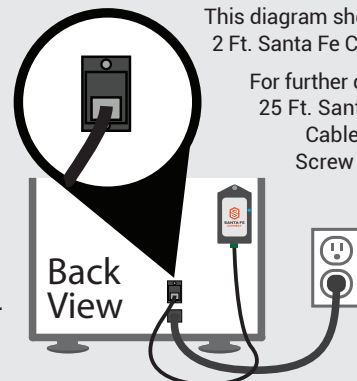

This diagram shows using the 2 Ft. Santa Fe Connect Cable.

For further distances, the 25 Ft. Santa Fe Connect Cable and Hanging Screw may be used.

TS-1068 8/18 Rev C

After installing your Santa Fe Connect Monitor using the instructions on the other side, follow the steps below.

**Step 6:** Download the Santa Fe Connect app by searching "Santa Fe Connect" on the App Store or Google Play.



**Step 7:** Launch the Santa Fe Connect app and select **Sign Up**.

**Step 8:** Enter your account details and select notification preferences. Then select **Create Account**.

**Step 9:** If this is your first time installing a dehumidifier, follow the instructions in **Image A**.

If you are installing your second dehumidifier, you can choose the + icon from the bottom of the side menu, as shown in **Image B**.

Image A

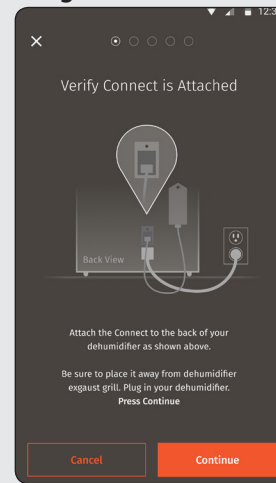
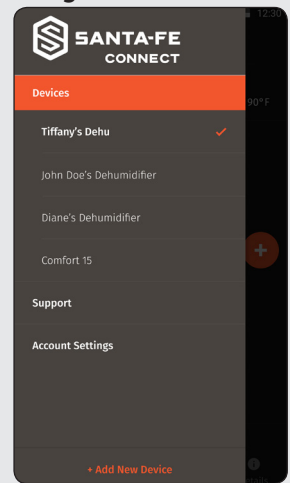

Image B



## LED Indicators

- Blinking Blue:** Setup mode (ready to accept new WiFi credentials).
- Blinking Green:** Connecting to local WiFi network.
- Blinking Turquoise:** Connecting to Cloud.
- Breathing Turquoise (fading in and out):** Connected to the Cloud.



For Product Manual and Troubleshooting Guide, visit [www.Santa-Fe-Products.com/Santa-Fe-Connect](http://www.Santa-Fe-Products.com/Santa-Fe-Connect) or call 1-800-533-7533.

After installing your Santa Fe Connect Monitor using the instructions on the other side, follow the steps below.

**Step 6:** Download the Santa Fe Connect app by searching "Santa Fe Connect" on the App Store or Google Play.



**Step 7:** Launch the Santa Fe Connect app and select **Sign Up**.

**Step 8:** Enter your account details and select notification preferences. Then select **Create Account**.

**Step 9:** If this is your first time installing a dehumidifier, follow the instructions in **Image A**.

If you are installing your second dehumidifier, you can choose the + icon from the bottom of the side menu, as shown in **Image B**.

Image A

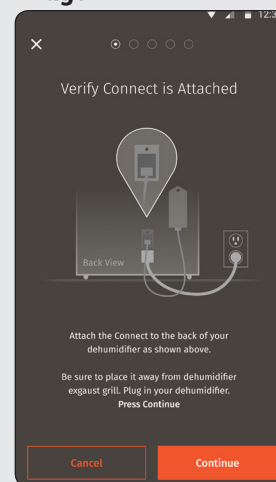
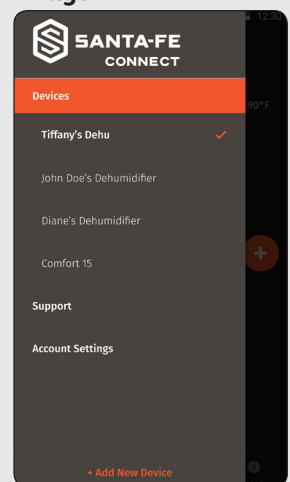

Image B



## LED Indicators

- Blinking Blue:** Setup mode (ready to accept new WiFi credentials).
- Blinking Green:** Connecting to local WiFi network.
- Blinking Turquoise:** Connecting to Cloud.
- Breathing Turquoise (fading in and out):** Connected to the Cloud.



For Product Manual and Troubleshooting Guide, visit [www.Santa-Fe-Products.com/Santa-Fe-Connect](http://www.Santa-Fe-Products.com/Santa-Fe-Connect) or call 1-800-533-7533.